



3/8" BORE BRASS MINIMATIC® CYLINDER

3SS-AR-1/2

Mount: Stud
Type: Single Acting
 Spring Extended

Available Stroke Lengths: 1/2"

Add **-N** to the end of the part number for a non-threaded rod

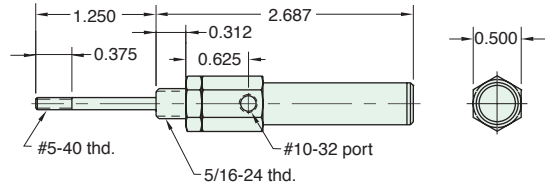

Rod nut included, but not shown on drawing

3PS-1/2

Mount: Body
Type: Single Acting
 Spring Return

Available Stroke Lengths: 1/2"

Ports: End or Side

Brass Rod - non-rotating

First Cylinder - 1949

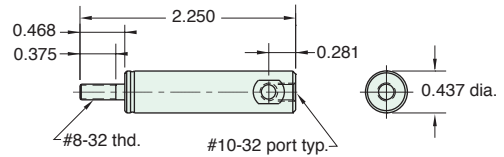

Rod nut included, but not shown on drawing

3SS-□

Mount: Stud
Type: Single Acting
 Spring Return

Stroke Length "L"	1/2"	1"	2"	3"
	2.093	3.343	5.218	7.093

To order: Add stroke length to the end of the part number

Add **-T** to the end of the part number after stroke for a #10-32 x 1/2" rod thread

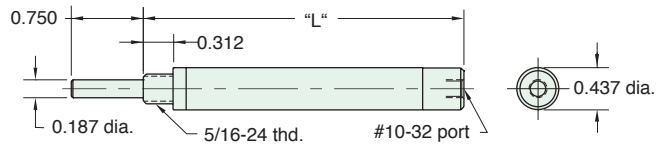

3CS-□

Mount: Clevis
Type: Single Acting
 Spring Return

Stroke Length "L"	1/2"	1"	2"	3"
	2.468	3.406	5.281	7.156

To order: Add stroke length to the end of the part number

Add **-T** to the end of the part number after stroke for a #10-32 x 1/2" rod thread

